



CROWNE PLAZA CANBERRA

1 Binara Street, Canberra ACT 2601, Australia
+61 2 6274 5500 eventscanberra@ihg.com

CROWNE PLAZA®
— BY IHG —
Canberra

canberra.crowneplaza.com

IHG® Business Rewards |  | 

Accommodation, Meetings & Events

CROWNE PLAZA®
— BY IHG —
Canberra

Crowne Plaza Canberra acknowledges the Ngunnawal people as the traditional custodians of the Canberra region. We pay our respects to elders past, present and emerging and acknowledge their spiritual connection to country. This is Tidbinbilla land, always was, always will be.



WELCOME TO

CROWNE PLAZA CANBERRA

Get ready to elevate your events at Crowne Plaza Canberra, where meetings and events transform into unforgettable experiences right in the heart of the action. Just a hop, skip, and jump from all the Nation's Capital has to offer!

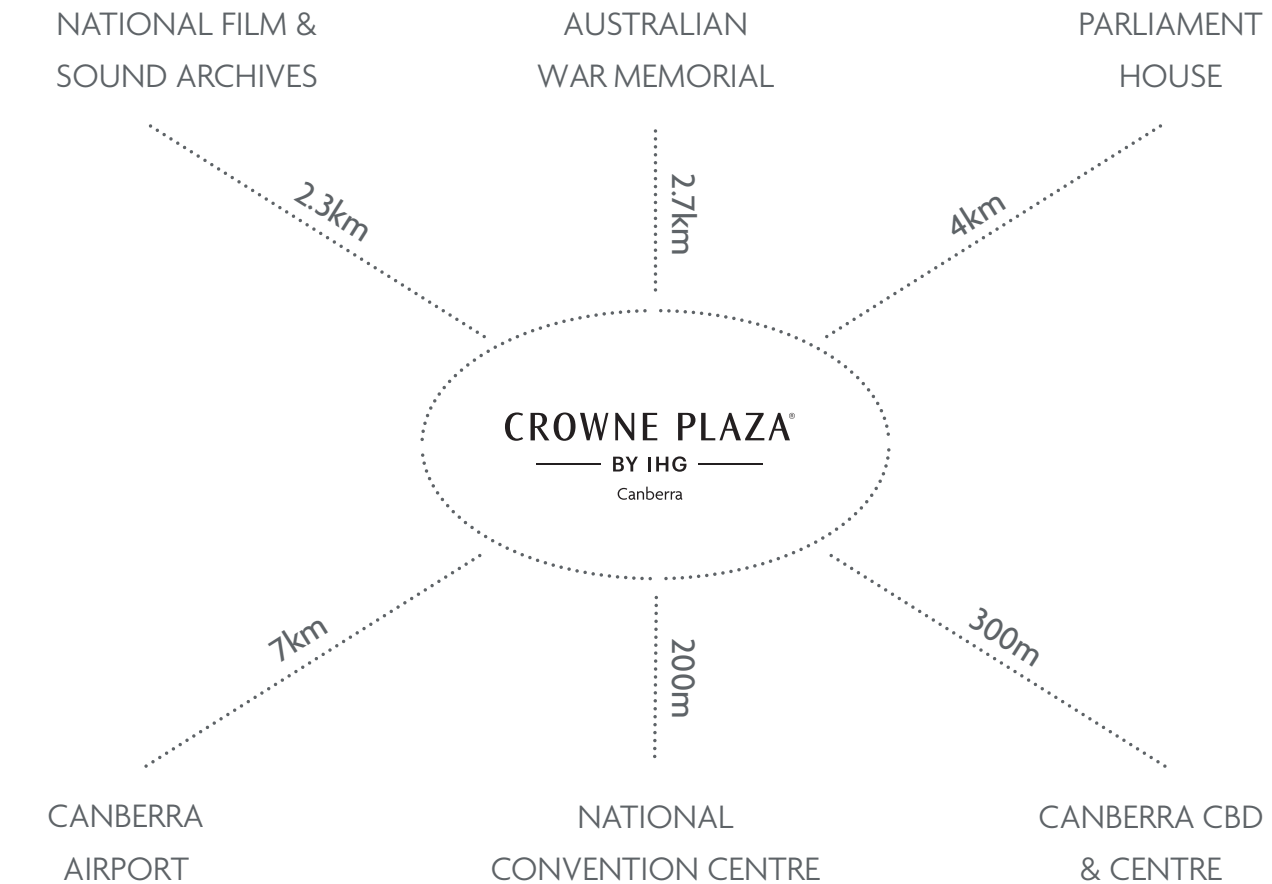

OUR CONVENTION PARTNER

Located 200 meters from our doorstep, The National Convention Centre Canberra (NCCC) is the capital's largest, purpose-built conference, meeting and events venue.

Offering 15 flexible spaces over two floors, they are unrivaled in facilities, size and scope. With an abundance of natural sunlight, pillarless space, on-site car parking facilities and a central location.

The NCCC is equipped to deliver events of all sizes, including gala events, conferences, exhibitions, and concerts for up to 2,448 delegates.

Crowne Plaza Canberra and The National Convention Centre Canberra are sister properties, both belonging to the IHG family.



WHY CHOOSE

CROWNE PLAZA CANBERRA

Our Canberra CBD location in a tranquil park setting is convenient for all meetings and events. From small and mid-sized events, including board meetings, seminars, training sessions, team planning days and university exam venues to a dinner for up to 90 guests or cocktail parties for up to 150.



DINING & DRINKS

Transition from work to play seamlessly with an array of catering options from plated lunches, mouth-watering canapes and seasonal buffets followed by post event celebratory drinks at our relaxed LUME Bar.



GUEST ROOMS

Enjoy true comfort, space, tranquillity and a choice of views.



DESTINATION EXPERTS

Access to our network of expert preferred event production, theming and team-building suppliers.



MULTI-FLEXIBLE SPACES

8 event spaces with over 650sqm of multi-flexible event and meeting spaces.



ON-SITE EVENTS EXPERTS

A dedicated on-site Events team, including expert event managers & directors, intuitive service team, onsite AV technicians and dedicated culinary team.



FREE LOYALTY PROGRAMME

From board meetings and conferences to weddings and social events, we understand the work that goes into planning and we think all your bookings are important, so we reward you no matter the size with our IHG Business Rewards programme.



BETTER CONNECTED

Free fast WI-FI and market-leading built-in Audio-Visual Technology with multi-room connectivity to produce hybrid and virtual event formats on multiple platforms.



FUNCTION ROOM CAPACITIES

ROOM	DIMENSION (M)	FLOOR AREA (SQM)	CEILING HEIGHT	THEATRE	U-SHAPE	BOARDROOM	CABARET	HOLLOW SQUARE	CLASSROOM	BANQUET	COCKTAIL
The Glebe*	25 x 6	152	3.9	150	40	48	80	–	36 / 54	100	150 + Terrace
The Crossings	16 x 6.2	128	2.8	90	36	42	48	54	30 / 45	80	80
Crossings	1 8.8 x 8	64	2.8	40	20	20	24	24	12 / 18	30	40
Crossings	2 8.8 x 8	64	2.8	40	20	20	24	24	12 / 18	30	40
Aquilla	12.2 x 8.2	91	2.6	60	27	20	32	24	18 / 27	50	60
Binara*	22 x 5	110	2.5	80	30	27	48	24	20 / 30	60	120
Pods 1	6 x 7	42	2.2	30	18	18	16	24	10 / 15	30	25
Pods 2	8 x 8	64	2.5	40	21	18	24	24	18 / 27	40	30
Fireline	4.6 x 8	56	2.5	30	15	18	16	18	8 / 12	20	20
Sunken Foyer	10 x 7	68	–	–	–	–	–	–	–	–	70
Atrium Pod	5.5 x 3.6	19	–	–	–	7	–	–	–	–	–
RedSalt Restaurant	18 x 10	180	–	–	–	–	–	–	–	110	200

* Excluding Terrace

FUNCTION ROOMS

THE GLEBE

Premium event space with floor to ceiling windows overlooking Canberra's iconic Glebe Park. This multipurpose room has exclusive access to the outdoor terrace and the ability to utilize LUME Bar sunken lounge as registration or catering breakout.



THE CROSSINGS

The perfect private event room. Complete privacy is offered with The Crossings Room, perfect for your confidential meetings or dinners. This space also lends itself to functional workshops and seminars. The Crossings is located on our Park Level and is equipped with a removable wall to create two smaller workshop rooms for event breakout sessions.



AQUILLA

The Aquilla Room is a unique event space with a long history. Located on the Reception level, this room is functional, allowing for a variety of set up styles and has natural daylight from the internal glass, facing the hotel atrium.

Aquilla contains a built-in bar, which during meetings can be closed off, or for dinner events utilized to service the event.



PODS 1 & 2

Located on our Reception level, the Pods are private and sequestered down the western wing of the hotel to ensure a productive and seamless event for you. They are perfect for that team training, meeting or workshop, as well as intimate product launch or seminar.

Boasting a large window wall that allows ample natural light, The Pods Room is/are extremely versatile.



BINARA

A unique, light-filled event space that offers a versatile portfolio of set up styles. Binara has been re-purposed from its original hotel bar conception, to now provide a funky and comfortable event space.

Binara offers not only an internal hotel entryway, but also a double door access from Binara Street, perfect for those grand entrances. Suitable for workshops and seminars, Binara is also a great choice for social events, including cocktail parties, seated dinners, BBQ buffets, and more.



FIRELINE

Located on level 6 of the hotel, Fireline is a wholesome meeting space, perfect for those intimate boardroom meetings or workshops. Providing ample natural daylight, Fireline also has casual lounge seating included in the space.



RECEPTION LEVEL *Floor Plan*

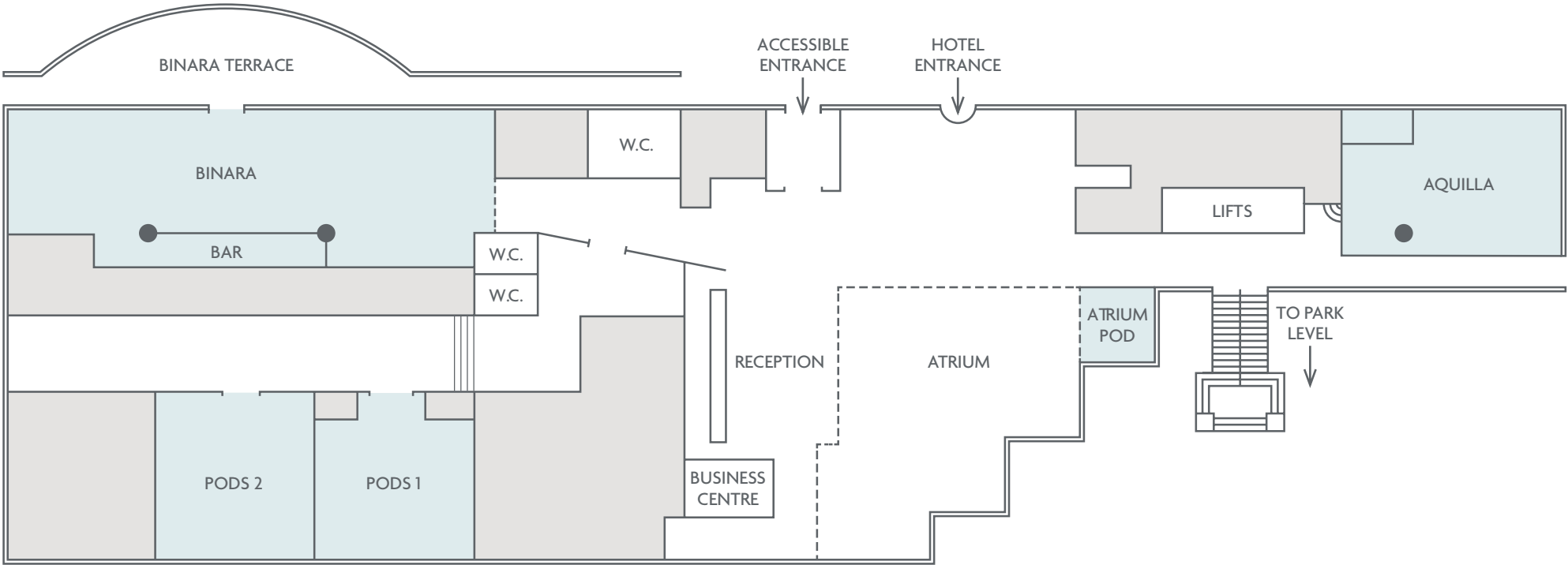

PARK LEVEL *Floor Plan*

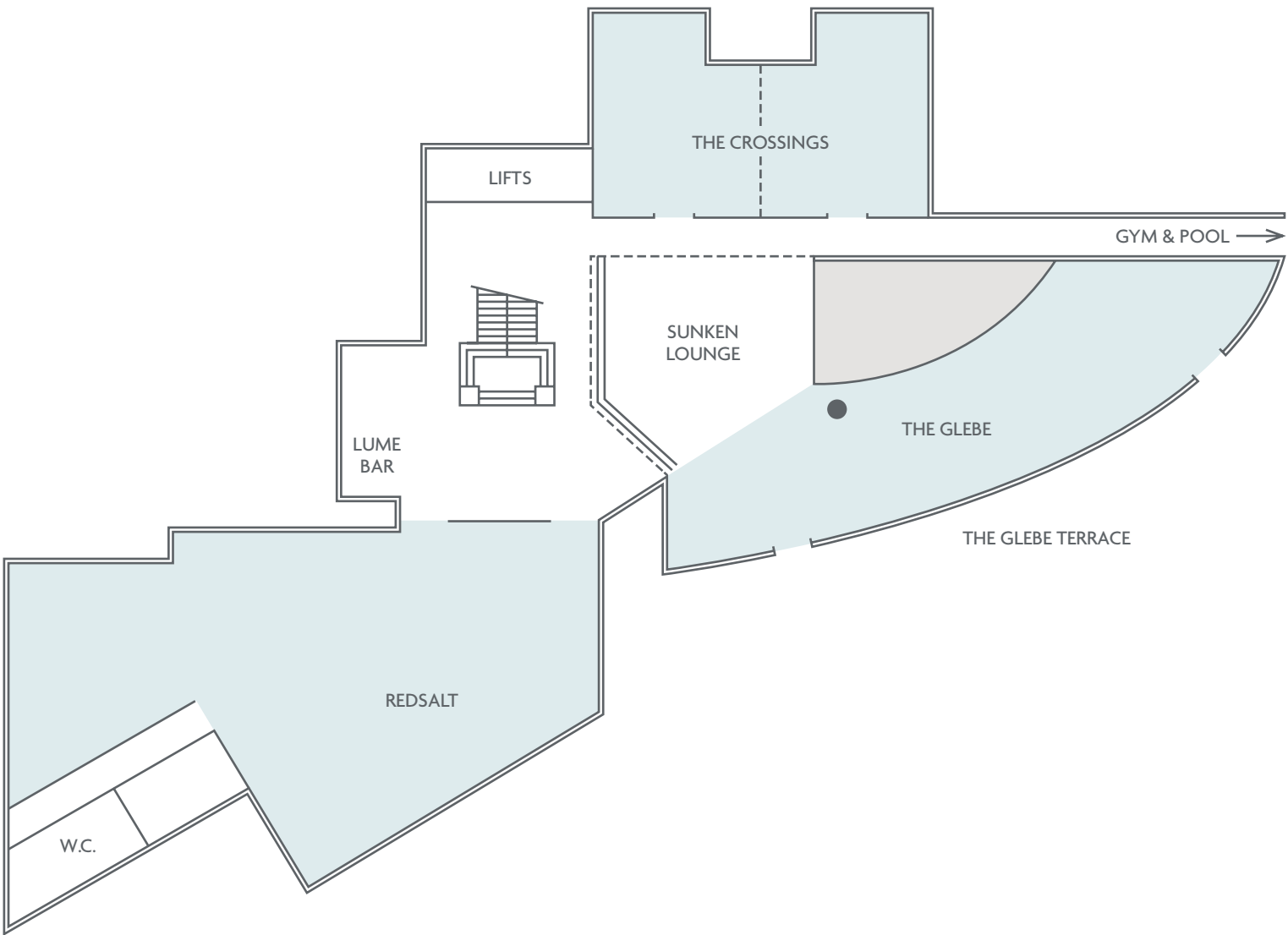



STAY IN STYLE

GROUP ACCOMMODATION

Sleep easy knowing we've got you covered

ACCOMMODATION

296	Hotel Rooms	130	Twin Rooms <i>2 double beds</i>
6	One-bedroom Suites	151	King Rooms <i>1 king bed</i>
1	Presidential Suite	8	Deluxe Triple Rooms <i>2 double beds + 1 sofa bed</i>

FACILITIES



Outdoor Pool



Fitness Centre



Business Centre



LUME Bar



24 Hour In-Room Dining



Accessible Guest Rooms



RedSalt Restaurant



Underground Secure Parking



OUR *Partners*

ELITE EVENT TECHNOLOGY

EET is focused on providing the highest level of technical equipment and personnel in Canberra. With the region's largest and most sophisticated inventory, experienced and passionate staff, EET can bring your vision to life.

Neil Whiteley – Venue Sales Manager

P 02 6260 2311 **M** 0439 670 054

E neil@eetechnology.com.au



PINNACLE TEAM EVENTS

Pinnacle Team Events creates unforgettable team building experiences that help unify and grow teams enabling them to work better together. Ask about their tailored programs for our event spaces or Glebe Park!

Pinnacle Team Events

P 02 4962 5034

E info@pinnacleteamevents.com.au



NATIONAL CONVENTION CENTRE

Conference with NCCC and sleep at Crowne Plaza Canberra. Located 200 meters from each other, proudly affiliated as sister properties under the IHG banner.

Liz Bendeich – Director of Sales & Marketing

M 0411 250 557

E liz.bendeich@ihg.com



BE CHALLENGED

Be Challenged specialises in workshops and programs designed to foster team cohesion, personal growth, skills and job satisfaction. Ask them about their tailored programs fit for our hotel, indoor or outdoor.

Oliver Sheer – Managing Director

M 0422 075 362

E oliver@bechallenged.com.au



IMAGINE EVENTS

Imagine Events offered event styling for all types of events, private and corporate. Select from our wide range of event styling products and let the team make your styling dreams come true.

Melanie Caragh – Stylist & Director

M 0430 112 588

E melanie@imagineevents.com.au



EXPERIENCE OZ

Experience good times. Book tours, experiences and adrenalin inducing activities around the Canberra area with Experience Oz. Ask our team for a 10% off discount code.

Book your experience below

W experienceoz.com.au

Use: CROWNECANBERRA10





Image courtesy of Tourism Australia

DESTINATION

CANBERRA

TRUFFLE HUNTING

Dogs, truffles and dining! Organise a team experience foraging and hunting for your own truffles, learning about nature and understanding the flavours of the mighty truffle. A beautifully Canberran experience.

We partner with two truffle farms – Turalla Truffles and Macenmist Black Truffles and have several packages available, plus a 4-course degustation dinner event.

PARLIAMENT HOUSE BEHIND THE SCENES TOUR

Discover the must-see highlights within Parliament House from the towering flagpole to the Great Hall Tapestry, the architecture, the chambers of the Senate and House of Representatives, art and craft, history and events, and some hidden surprises.

UNIQUE NATIONAL ATTRACTIONS

National Arboretum Canberra – nationalarboretum.act.gov.au

National Museum Australia – nma.gov.au

National Portrait Gallery – portrait.gov.au

The National Film & Sound Archive of Australia – nfsa.gov.au

LAKE BURLEY GRIFFIN BOATING

Love Boats

Set sail on an unforgettable adventure with Love Boats, Canberra's premium self-drive boat hire and ferry charter on Lake Burley Griffin.

Go Boats

Rent a GoBoat with your crew and enjoy Canberra from a totally new angle!

AUSTRALIAN WAR MEMORIAL LAST POST CEREMONY

Commencing at approximately 4.30 pm AEDT, the Memorial farewells visitors with its moving Last Post Ceremony in the Commemorative Courtyard. Each night the ceremony shares the story behind one of the names on the Roll of Honour.

ADVENTURE ACTIVITIES

KingPin – Escape Rooms, Karaoke, Bowling, Laser Tag, Arcades and more!

Status Golf Simulator – Indoor Golf Centre

Holy Moley Canberra – Mini Golf, Escape Rooms and Karaoke

Canberra's National Arboretum –

Tree-top adventure with zip lines and rope courses.

Balloon Aloft – Early morning balloon flights over Canberra, providing a unique perspective of the city's landmarks.



FLEXIBLE REWARDS

IHG BUSINESS REWARDS



Not all heroes wear capes and you are definitely one of them. We believe in celebrating you – the unsung hero who quietly orchestrate seamless accommodations and coordinate impactful meetings and events for others.

Earn 3 points for every \$1 USD spent on qualifying bookings, with the flexibility to use these rewards towards corporate benefits or add them to your personal account. No catch, no booking threshold, and no minimum qualifying spend – just a straightforward acknowledgment of your hard work.

FEEL-GOOD SPENDING

Donate approx. 2,500* points to OzHarvest and help deliver twenty meals to those in need. OzHarvest is Australia's leading food rescue organisation with a driving purpose to Nourish Our Country.



BARGAIN SPENDING

Looking to do some home improvements? Swap approx. 33,000* points for a \$100 Bunnings Gift Card. Treat yourself to that new outdoor furniture or lawnmower.



GETAWAY SPENDING

Need to escape that Monday blues? Invest approx. 91,000* points in a one-night stay at the Crowne Plaza Fiji Nadi Bay Resort and Spa. Pack your bags; your retreat awaits.

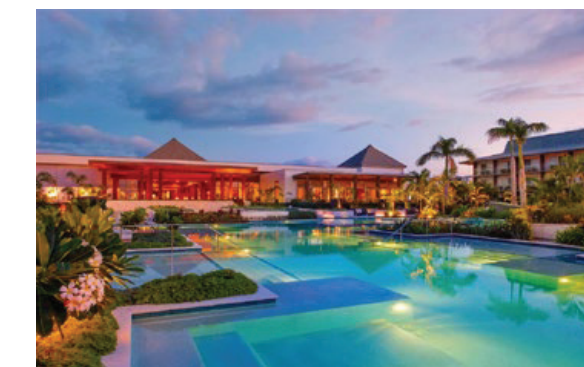

JOURNEY TO *Tomorrow*

IHG[®] HOTELS & RESORTS

IHG'S 10-YEAR RESPONSIBLE BUSINESS PLAN

Our goal is to help shape the future of responsible travel together with those who stay, work and partner with us. We will support our people and make a positive difference to local communities, while preserving our planet's beauty and diversity...not just today but long into the future.



Champion a diverse culture where everyone can thrive.



Improve the lives of 30 million people in our communities around the world.

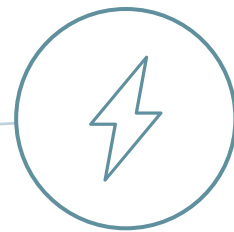

Reduce our energy use and carbon emissions in line with climate science.

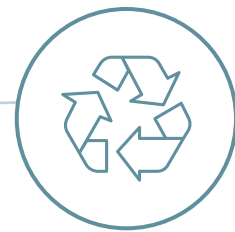

Pioneer the transformation to a minimal waste hospitality industry.

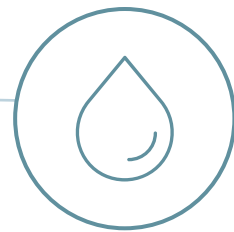

Conserve water and help secure water access in those areas at greatest risk.

EMPOWER OUR PEOPLE TO HELP SHAPE THE FUTURE OF RESPONSIBLE TRAVEL



OUR PEOPLE

- Drive gender balance and a doubling of under represented groups across our leadership.
- Cultivate an inclusive culture for our colleagues, owners and suppliers.
- Support all colleagues to prioritise their wellbeing and the wellbeing of others.
- Drive respect for and advance human rights.



COMMUNITIES

- Drive economic and social change through skills training and innovation.
- Support our communities when natural disasters strike
- Collaborate to aid those facing food poverty



ENERGIES & CARBON

- Implement a 2030 science- based target that delivers 46% absolute reduction in carbon dioxide emissions from our owned, leased, managed and franchised hotels.
- Target 100% new build hotels to operate at very low/zero carbon emissions by 2030.
- Maximise/optimize the role of renewable energy.



WASTE

- Eliminate single use items, or move to reusable or recyclable alternatives across the guest stay.
- Minimise food going to waste through a "prevent, donate, divert" plan.
- Collaborate to achieve circular solutions for major hotel commodity items.



WATER

- Implement tools to reduce the water footprint of our hotels.
- Mitigate water risk through stakeholder collaboration to deliver water stewardship at basin level.
- Collaborate to ensure adequate water, sanitation, and hygiene (WASH). conditions for our operating communities



LOCATION

OUR NEIGHBOURS

1	National Convention Centre	200m
2	Canberra CBD	300m
3	Canberra Centre	800m
4	Canberra Theatre	900m
5	National Museum of Australia	2.2km
6	National Film & Sounds Archives	2.3km
7	Australian War Memorial	2.7km
8	Parliament House	4.0km
9	National Library of Australia	4.7km
10	Canberra Airport	7.0km
11	Jerrabomberra Wetlands Nature Reserve	7.0km
12	Pialligo Redwood Forest	9.0km

